

OFFICIAL NEWSLETTER OF  
DIVISION SIX OF THE  
NORTH CENTRAL REGION  
OF THE NATIONAL MODEL  
RAILROAD ASSOCIATION

## DIV 6 MEETINGS

Our Division 6 meetings are on the **THIRD** Friday of each month and our next Division 6 meeting will be on **FRIDAY, JUNE 18, 2010**. The meeting will be held at the Civic Center Senior Center in Livonia, at 5 Mile and Farmington Roads. The meeting is from 7:30pm until 10pm.

## DIV 6 FALL SHOW

Even though we are sponsoring the NCR convention, we will be doing the annual Fall Show and Workshop too! And it's just about time to start considering the show and it's operation. While our date is set, the Sunday after Thanksgiving, November 28, 2010, we still need other stuff done soon. We also need a new Chairman. Dick Harden has resigned and a replacement is needed. If you are interested, please see/call/email Glenn as soon as possible.

## PRODUCT REVIEW

We did have a product review this month, done by Dave Jakubiak. Dave gave a review of a video bought from Greg Neff video at a local train show. The video was of the Michigan and Ohio RR, by C-vision. The video was shot at the same time as pictures were taken for a DT&I book. Thus the video compliments and is an extension of the book! If you have an item to review, see Glenn before the meeting starts.

## TOOL TIME

Div 6 member Bill Deeter gives us a look at some interesting and useful tools - This month it was a drill set costing \$60-70. The Forstner drill bits, used for making holes, but unlike cheap hole drills, they do not cut a "disk" to make the hole. They are full blade drills, so they clean-up/out the hole. This is really good if it is not a through hole. They can also be used on angles! They are made in sizes from .25" to 2.125" Also Brad point drills, work the same, are smaller sizes and keep you centered.

# ON THE RAILS...

## JUNE 2010

Hmmmm... 2010 is near half over! That also mean the NCX convention is getting ever so nearer!! Are you ready? Some great new news in the NCX report article!

The weather has been HOT lately, near summer like and more! Have you been visiting your layout lately? Have you noticed it's nice and cool in your basement/layout area? See, model railroading can be a year round hobby - cool in the summer heat and warm indoors during the winter cold! Keep on model railroading!!

Interesting editorial in the new July Model Railroader magazine, about making lists to keep you on track, working and getting things done on your layout. Indeed... I believe I have suggested the same methods. And timely, as we do have that convention approaching! Now, here's the rest of your Div 6 news-

## MEMBERSHIP NEWS

We had LOTS of new members at the last meeting. NEW were- Burt McNeal, JC Paschal, Chris Stark, Stuart Packard, and Bill Schmitz. WOW, we've never had that many new members at one meeting! Welcome aboard guys!! They all received our new member goodie bags! To all Div 6 members, WELCOME ABOARD!

## SHOW AND TELL

The subject for the last meeting was off line structures, which is any structure NOT serviced or owned by the railroad. Items shown were- company housing house, DPM taxi co, saw mill display, gold mine, AHM farm house, warehouse, billboard, workshop, power house & electric yard substation, general store, church with interior, fire station (from 1960 MR article), company house, bar/inn DPM kit, industry bldgs Sn3, 4 company houses assembled differently, farm house, fishing shack, dentist office - kitbash, fire house, military storage bunkers, Quonset hut, ash pit conveyor, Billboard, out house, Bar Mills Wicked Wanda's, N scale bakery, town stores, kitbash covered highway bridge, house, wood store kit.

Current projects included- taking part of the layout apart to fix wall leak, water column, 0 scale steam engine, girder bridge, boxes to hold radios placed around layout - like phones, PRR work train cars, 0 scale mill gon. We did have some members donate to the caboose. Thanks to those that did.

**NEXT MEETING-** cars that carry hazmat materials - tank cars, open & covered hoppers, box cars and even gondola cars!

## DIV 6 WEBSITE

The new Div 6 website is up. Check it out at- [www.div6-ncr-nmra.com](http://www.div6-ncr-nmra.com)

### LARRY'S TROPHIES-ENGRAVING-SIGNS

awards-labels-nametags-plaques-decals  
buttons-mouse pads-coffee mugs  
key chains-luggage tags-tshirts

**734-634-1226**

[larrystrophy@sbcglobal.net](mailto:larrystrophy@sbcglobal.net)

## CLASSIFIED ADS

We are happy to place classified ads for Div 6 members. Donations to the Div of \$2 per ad is requested! And don't forget our "Surplus Table" at every meeting where you can bring in items for sale.

## DIVISION 6 BOARD OF DIRECTORS

**Superintendent-** Glenn Joppich  
734-464-6004 [steambigot@yahoo.com](mailto:steambigot@yahoo.com)  
**Asst. Superintendent-** Bill Rubarth  
734-522-5876 [wrubarth@twmi.rr.com](mailto:wrubarth@twmi.rr.com)  
**Secretary-** Howard Andrews  
734-728-4697 [hwandrews@wowway.com](mailto:hwandrews@wowway.com)  
**Treasurer-** Larry Wolohon  
734-454-4816  
[larrywolohon@comcast.net](mailto:larrywolohon@comcast.net)

### OTHER PEOPLE WHO DO STUFF

Newsletter- Barry Hensel  
734-397-5182 [Barry76Lt@wowway.com](mailto:Barry76Lt@wowway.com)  
Clinics- Howard Andrews  
734-728-4697 [hwandrews@wowway.com](mailto:hwandrews@wowway.com)  
Layout Tours- **volunteer needed!!**  
History- Norm Logan  
248-348-2473 [nlogan114@wowway.com](mailto:nlogan114@wowway.com)  
Webmaster- Ed Beamish  
734-266-2301 [nedbeam@provide.net](mailto:nedbeam@provide.net)  
Div 6 Fall Show- **volunteer needed!!**  
Meeting Coffee- Walt Plentis  
248-535-8063 [wwp4343@comcast.net](mailto:wwp4343@comcast.net)

## WHO WE ARE

We are Division 6 of the North Central Region (NCR) of the National Model Railroad Association (NMRA). What that means is, the NMRA is the model railroad association for the country (and even world). The country is divided into REGIONS, which are one or more states. Our Region, the North Central Region (NCR), is all of Michigan and the northern part of Ohio and Indiana. Each Region is then divided into DIVISIONS, which are one or more counties. Division 6 is primarily Wayne County, but we have many members from western Oakland County and we aren't strict on membership and boundaries. All total, there are about 8 Divisions in our Region.

## RAILROAD HISTORY

Norm was not present to do a History lesson this past month. Looking forward to another lesson next month.

## CLINIC

This month's clinic was by Brook Qualaman on scratch structure building. And Brook knows what she is talking about, having received 3 merit awards!! The clinic showed how Brook researched and built HO scale versions of several family homes. Use google maps to look up structures - they have street level pictures and can rotate and see all sides - great for doing models of a structure clear across the country! Tools used - scale ruler, xacto knife, Tenx and model master glue, cutting pad, box cutter for "big" cuts, and used parts from different scales to make parts needed.

Using Sanborn maps from library to see how buildings were laid out and dimensions of structures. Also use old family photos for house pictures!

How to build- draw simple outline of house, sketch walls of house, write part numbers (windows/doors, etc) on sketches, build cardboard mock-up, number wall sections to keep track of where they go, use lots of bracing to keep models square and straight, paint parts separately, dull coat windows on the inside to keep outside shiny! Another great source for pictures of long gone structures are Acadia or Postcard books.

I believe this is the first time we've had a clinic by a member's wife (or any woman) and it was great!! Congratulations Brook on a great clinic, full of good info!! Thanks! If you are willing to do a clinic, please, e-mail or call or see Howard at the meetings and share your thoughts.

**NEXT MEETING-** Rich Mahaney on hazmat for model railroads

## CALENDAR OF EVENTS

**Sunday-Sunday, July 11-18** - NMRA  
75<sup>th</sup> annual National Convention  
Milwaukee, WI  
Times- varies each day  
Admission Fees- \$60 - \$175+  
Contact Info- [www.nmra75.org](http://www.nmra75.org)

## MODELING INFO W/LARRY

Here are **LARRY'S TIPS** for this month- Larry showed a MCD coffee stir stick- for signs and sign posts; use hair clips modified for clamps, twigs for cut wood, use alum foil cut-off strip from box - cut to make logging cross-cut saw!; T pin taped to block of small wood to use to position figures in tight spaces; split twigs with xacto blade and small hammer - like splitting real wood for details; wax paper on sheet of balsa wood to act as a movable work surface  
Thanks Larry for some great info!

### **OTHER TIPS-**

Doug Meyer has idea for free foam - go to trailer sales company - trailers are stacked with BLOCKS of white Styrofoam and they will give them to you for free, as they are scrap to the sales dealer!! Approx size 12x12x24 and SOLID!

We look forward to more questions, tips next month!

## NCX - NCR-DIV 6 2010 CONV

The **North Central Express** dates are **October 21-24, 2010!**

BIG NEWS - we have confirmed two proto-type tours of the NS/Triple Crown facility in Melvindale! These will take place Friday afternoon. One tour will see a train taken apart, while a second tour will see a train put together. We're still working on getting at least 2 more tours. We have finished with the layout tour planning and now have a total of about 40 layouts!

Operating sessions will start to be schedule soon. Clinics are next on our hit list of items to finalize. These are just about set and it looks like we will be adding a few more on Saturday afternoon! This should bring the number of clinics to approx. 24, between Friday night and Saturday morning and afternoon. The judges appear to be all set for the NCR Model & Photo contest room. Div 6 member BILL NEALE has replaced Dick Harden as the Layout Tour coordinator for the convention. Get ready- NCX is ONLY 5 months away!

## LAYOUT TOURS

We have our last Div 6 layout tours before the NCX convention. Thanks to Ted Pilchak, Walt Plentis, Don Barron and Dick Harden. All FOUR layouts will be open on Sunday, June 27th. See the map in this newsletter. We also have Jack Watson on tour as part of a Div 8 tour on Saturday, June 12<sup>th</sup> from 1pm-5pm. See that map too! Dick Harden has resigned as Div 6 Layout Tour Chairman. We need someone to fill this position, but we have time to fill it, as just mentioned, there will be no more tours until after the NCX convention. Then in December, Marty and Barry will hold their annual December Layout Tours. If you are interested in being the Layout Tour Chairman, please see Glenn.

**NEXT TOURS-** Four layouts on tour on Sunday, June 27th from 1-5pm AND Jack Watson on Saturday, June 12<sup>th</sup>.

See the map on the next page!! YES, these are our "northern" members in Div 6, but these layouts are well worth the trip!!

NOTE- Don Barron lives on a dirt road. Cooley Lake Rd between Carey and Bogie Lake is dirt. If you travel down to Commerce and then back up Cary to get to Don's, you will travel on much less dirt!

There is also a map to Jack's house on another page!!

## DIV 6 MISC NEWS

We may still buy a laptop to go with the projector. The decision is on hold till we check out the projector and all of it's features. Projector model number is- Epson LCD projector H335A If you have time to check this out online, please do so. We'd like many members to know how to work the projector.

A suggestion was made to make a Div 6 member roster. You do NOT have to be on the roster and only members will get the roster. John Wissenger will help and is looking to Howard who has current roster. Maybe a preliminary copy can be made for the next Div 6 meeting and we can do corrections on that copy.

Another suggestion was made to email the Div 6 newsletter, instead of regular mail. This will save the Div some postage and printing money. The plan has one draw-back and that is that those that want the newsletter via email MUST keep their email address current with Howard, our Div Secretary. Barry will get with Howard to get a email list and we'll try this with THIS issue. (we'll still mail it too for at least this month and maybe July too) Please let Howard know if you do NOT want to get newsletter via regular mail!

# DIVISION 6 LAYOUT TOURS

Sunday, June 27, 2010

1pm-5pm

Walt Plentis 248-535-8063

1721 Kristina Dr White Lake, MI 48386

Ted Pilchak 248-698-3603

118 Allen Lake Dr. White Lake, MI. 48386

Don Barron 248-779-1387

6685 Cooley Lake Rd White Lake, MI 48383

Dick Harden 248-889-2228

5744 Hidden Lane Ct White Lake, MI 48383

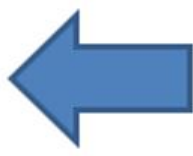

NORTH

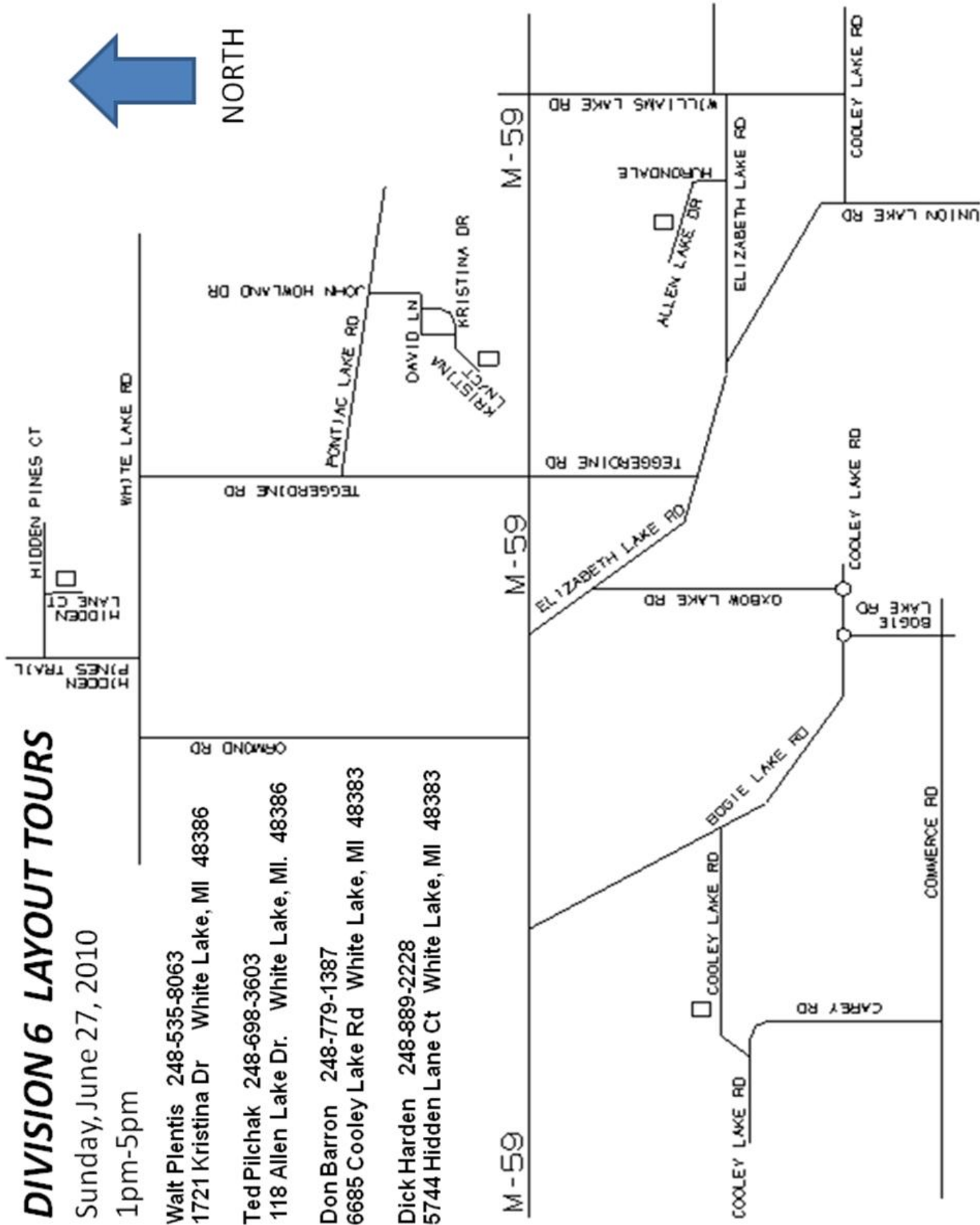

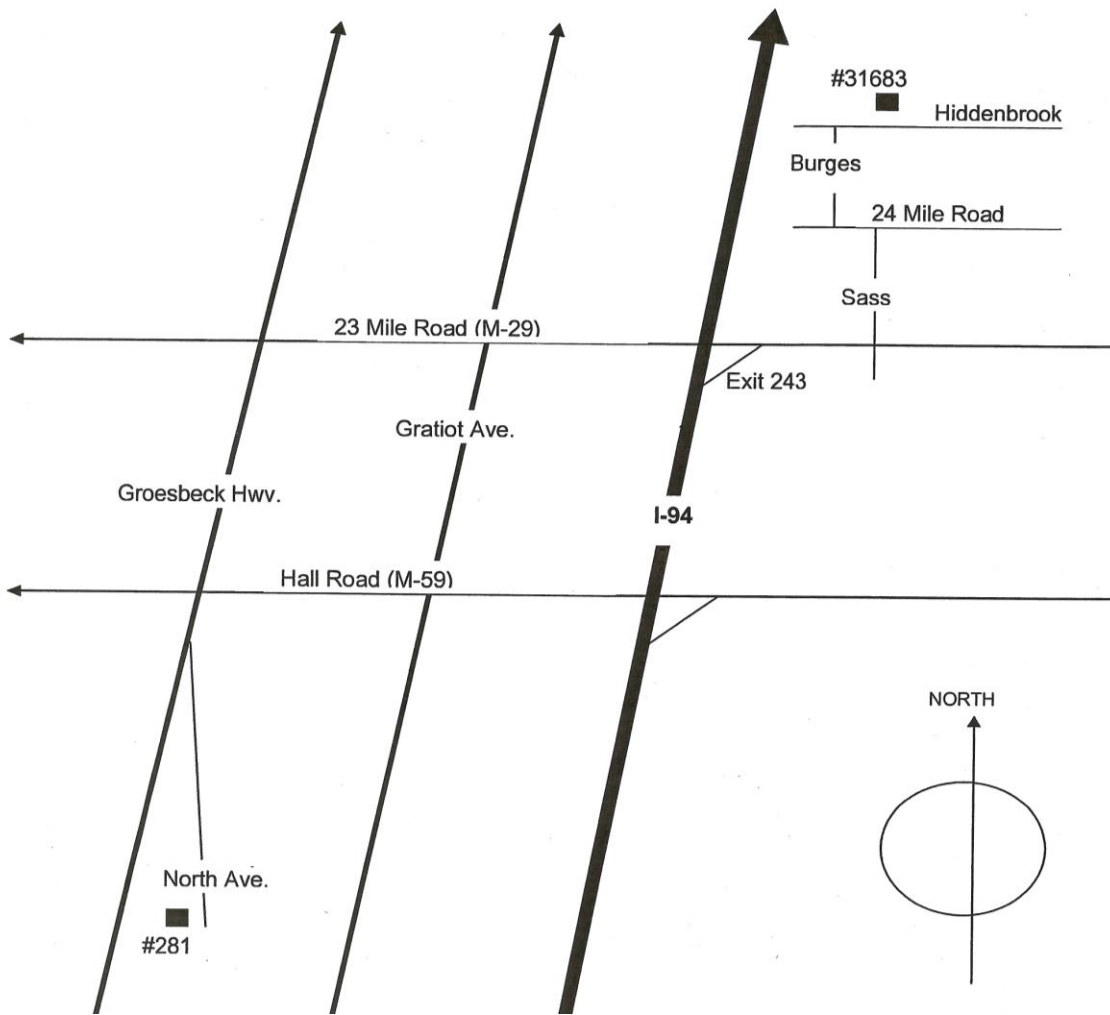

## Division 8 Summer Layout Open Houses June 12, 2010 (Saturday) 1:00—5:00 pm

### Gratiot Valley Railroad, 281 North Ave., Mt. Clemens, MI

The GVRR club celebrated its 35<sup>th</sup> birthday last October.

- 2500 sq. ft. HO railroad (with some HO<sub>N3</sub> trackage)
- 50/50 split of single and double track
- No duckunders, 48 inches to 6 feet in height
- 1945-1955 era (steam to diesel transition)
- Scenery includes wharf, coal mines, farm land, cities, industrial & mountains
- Two-level staging
- Digitrax control
- Library, work room, modular storage

### Jack Watson, 31683 Hiddenbrook

(586) 598-7407

The Boston & Maine, Connecticut River Line (HO scale)

- Western Massachusetts
- The line begins in Springfield and follows the river north to Deerfield
- Covers approximately 34 miles of mainline
- Mainline run is 175 feet, 77 turnouts, 3 diamonds, 4 crossings and 3 interchanges
- Era is Fall 1956
- Scenery mostly complete in cities (125 buildings)
- Control is Easy DCC wireless